



LOUPECam[®]

FIRST POINT OF VIEW CAMERAS FOR LOUPES & HEADLIGHTS

Product Catalogue



(614) 901-0662



sales@loupecam.com



www.loupecam.com

Loupe Cam[®] iQHD

The Novelty of Our Approach

The new iQHD LoupeCam[®] System is a 4K High Definition, 13 Megapixel video device which digitally acquires video data, mechanically stabilize the image through its miniature gimbal and autofocus and transfers it to your computer or a portable DVR via USB connection.



The Design

New design, new approach. Introducing the first 4K head-mounted camera with gimbal image stabilization and autofocus. A much wider 4K field of view allows for digital zooming up to 8x and post processing zooming to reach the magnified clinical details sought after by clinicians.

Specifications:

- Weight w. Standard Lens - 31g
- Weight w. Telephoto - 34g
- Compression - MJPG
- Video Format - .mp4
- Audio - External
- Security - HIPPA-Compliant

System Requirements:

- CPU - Intel Core i7/8GB RAM
- Graphic Card - Robust NVIDIA (or equivalent)
- Storage - Hard drive 1 TB+
- USB Port
- H.265 HEVC

4K
1080

LOUPECAM®



LoupeCam With Image Stabilization & Autofocus



Autofocus

No more manual lens calibration to your working distance. Sharp focus is obtained with a minimum distance of 18cm. Greater depth of field for more flexibility.

4K

4K Imaging

High-sensitivity Sony CMOS 13MP sensor offering a 4K maximum resolution of 4224 x 3136.



Gimbal Image Stabilization

The combination of gimbal anti-shake and electronic image analysis allows recording clearer images, absorbing head movement for improved video and stability.



Digital Zoom

Digital zooming allows over 4000 pixels to deliver a greater field of view, almost 4 times the size of 1080p. Software zooming enables clinicians to get close-up views of areas of interest while leveraging image stabilisation and autofocus.



Point Of View

The ability to leverage technology to see from a clinician particular visual perspective is key in a world where an image is worth a thousand words.



Field Of View

With two interchangeable lenses to choose from, with or without added magnification, specific clinical requirements for field of view are achieved.



Windows

USB-C Connectivity. Video format: .mp4
Supported resolution using recommended H.265 HEVC.



Mac

USB-C Connectivity. Video Format: .mp4
Supported resolution: Mac OS12/13 and newer using recommended codec H.265 HEVC.

Quality and Ingenuity

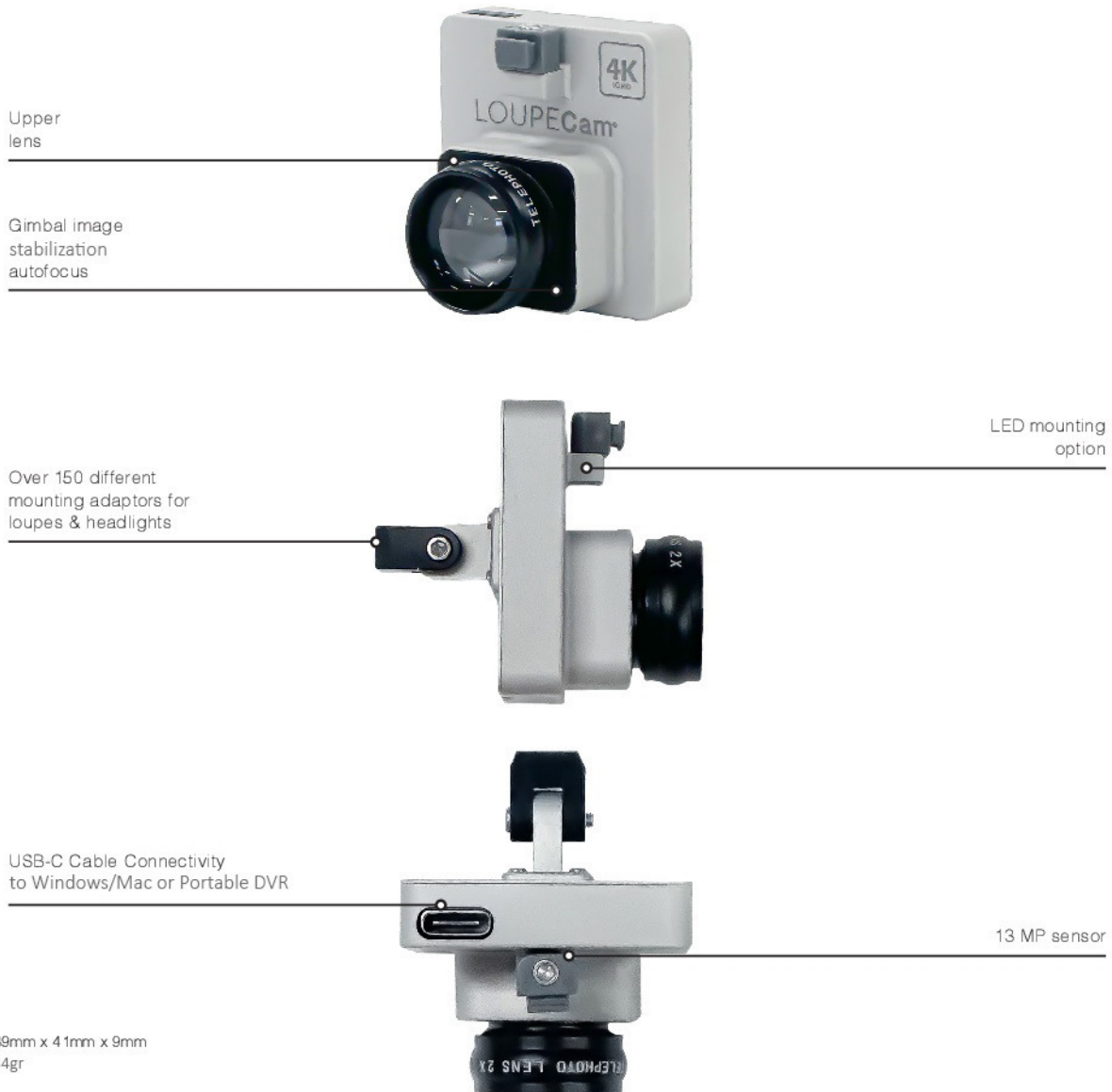

Dimensions: 39mm x 41mm x 9mm
Weight 31gr/34gr

Resolution, Format & Storage

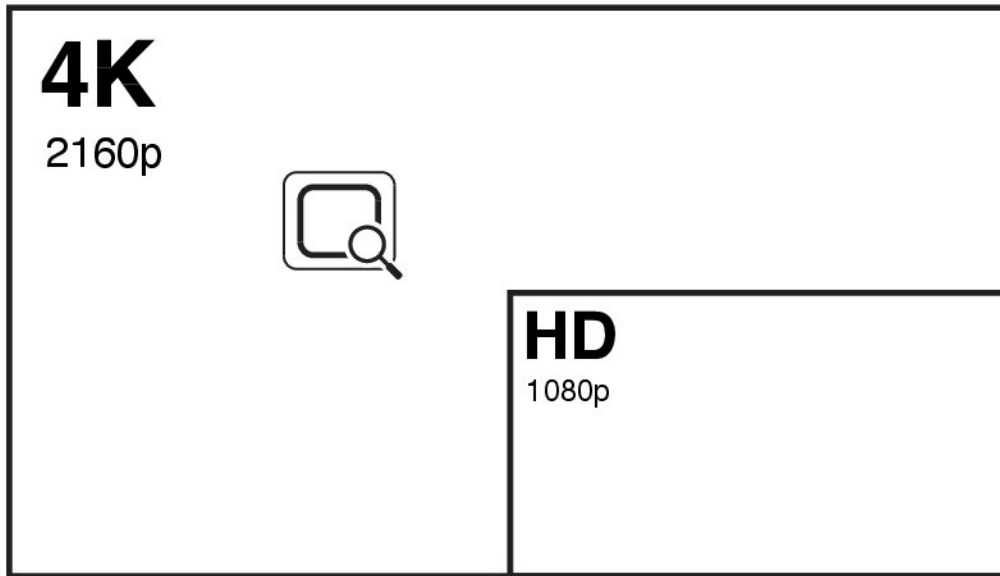

The iQHD LoupeCam® System offers different resolutions for recording with the associated storage space as follow:



Windows w. H.265 HEVC Codec

1. 3840x2160 (4K) ~ 5.8GB/H in .mp4
2. 1920x1080 (FHD) ~ 3.5GB/H in .mp4
3. 1280x720 (HD) ~ 2.8 GB/H in .mp4



Mac OS w. H.265 HEVC Codec

1. 3840x2160 (4K) ~ 12GB in .mp4
2. 1920x1080p (FHD) ~ 3.3GB/H in .mp4

Gimbal Image Stabilization & Autofocus

The iQHD LoupeCam® offers a miniature gimbal image stabilization and autofocus that operates between a range of at least 8" – 28" (20cm-71 cm) of object distance and does not require calibration.



Gimbal Lens Assembly
(Under the Upper Lens)

Upper Lens covers the
Gimbal Lens Assembly

Optical Zooming & Upper Lenses Options

There are 2 upper lens options to mount onto the gimbal lens assembly. The standard Lens and Telephoto Lens require to gently unscrew the existing lens and screw another one.

Optical Zooming



Upper Lens Option

Standard Lens

Telephoto Lens

The standard lens has a counter-screw for tightening. It offers a slightly wider field of view while the Telephoto lens offer a 2x magnification.

Note: When changing lenses, user might experience a temporary blurriness.
Reset the lens autofocus by setting the focus in manual mode in the software.

While only the upper lenses remain interchangeable, it is NOT recommended to operate the camera without at least one upper lens as it exposes the gimbal lens assembly to fluids which can ruin its mechanical assembly, thus voiding the warranty. The Gimbal lens assembly MUST remain protected by an Upper lens at all times.

Sterilization & Protection

The LoupeCam®4K iQHD & its accessories are not designed to be sterilized. All LoupeCam® products normal use are set outside of the sterilize zone.

Note: DO NOT STERILIZE THE CAMERA. Attempting to sterilize the camera or its accessories will most likely damage it, thus voiding your warranty. Avoid any contact with water, inclusionary of submerging underwater.

LoupeCam Mounting Adaptor

For Loupes:

Designs for Vision, Orascopic, Surgitel, Q-Optics,
Perioptix, Sheervision, Carl Zeiss, Heine
Univet, Pentax, Examvision, Bryant Dental
Admetec, Andau Medical, Xenosys and
Miscellaneous

Headlights:

Luxtec, Welch Allyn, BFW, SunOptics, Enova XLT - 125

Custom Adapter Design Service

Need a different mounting adapter?
Contact us to discuss your needs.



A universal clip that fits most loupes or prescription glasses



4K iQHD Back Mount 3 Adjustable Positions

The iQHD LoupeCam® offers 3 mounting adjustable positions. This allows users to determine the best ergonomic position (position 1, 2 or 3) for their loupes or headlights. User can modify the position by using the provided L-key.

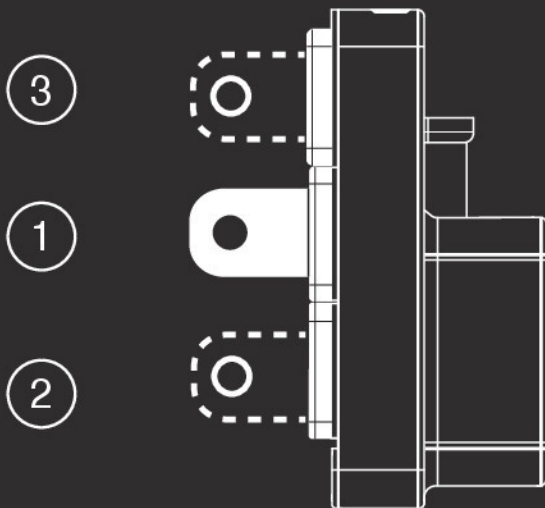

Allen Wrench
Included

LoupeCam LED Light 360

(Including Light, 2 Cables,
1 Charger, 1 Battery)

- Up to 60,000
- 4 levels of intensity
- Perfectly uniform circular beam
- Even edge-to-edge brightness
- Only 5.3g





LoupeCam Smart Battery

- Charging Time: 3 hours/full charge
- Battery Life: 15-40 Hours/based on the intensity.





Smart Charger when plugged in, note the LED indicator sequence:

1. Press to power on/off
2. Hold to change intensity (Low, medium, high, max)

 Smart Charger Working

 Battery Charging

 Battery Fully Charged

CAUTION:

1. Do Not Charge Battery over night/ unattended
2. Do not drop, immerse in liquids, or store in hot area
3. If the battery acts abnormally, contact us right away.

LoupeCam Bluetooth Footpedal (Optional Accessory)



The Bluetooth pedal allows the user to remotely activate the recording:

- Start Recording = Left side
- Stop Recording= Right Side

The pedal are programmed for a single command, regardless of how long/how many times it is being tapped.

Note: Once completely charged, it offers ~ 200 Hours of autonomy when switched off after use.

LED Indications

LED	Action	Meaning
Blue	Fast Blinking	Trying to connect to a host.
Blue	Slow Blinking	Connected to a host.
Blue	Solid On	Keystrokes sent.
Red	Slow Pulse	Low Battery.
Red	Solid On	Charging (Plugged In)
Blue/Red	Solid On	Battery Charged (Plugged In)



Portable DVR

(Optional Accessory)

Modular and Full-Featured Handheld PC

Easy to Take In Your Pocket!

CPU:	Intel i7
GPU:	Intel Iris Xe Graphics eligible 96 EUs
RAM:	16 GB
Hard Disk Space:	1TB
OS:	Windows 11
Screen Size:	5.5 inches
Touch Screen:	1920x1200
Network:	Wi-Fi: IEEE 802.11a/b/g/n/ac/ax R2 2x2 Supports 2.4G/5G/6G Wi-Fi 6.BT 5.2
Ports:	3x USB3.2 Gen2 ports -,all with a 10Gbps 1x Thunderbolt 4 1x USB 3.2 Gen2 Type-c, 1x HDMI 2.0b 1x RJ45.1x 3.5mm Headset
Dimension:	198x137x20 mm
Net Weight:	729g

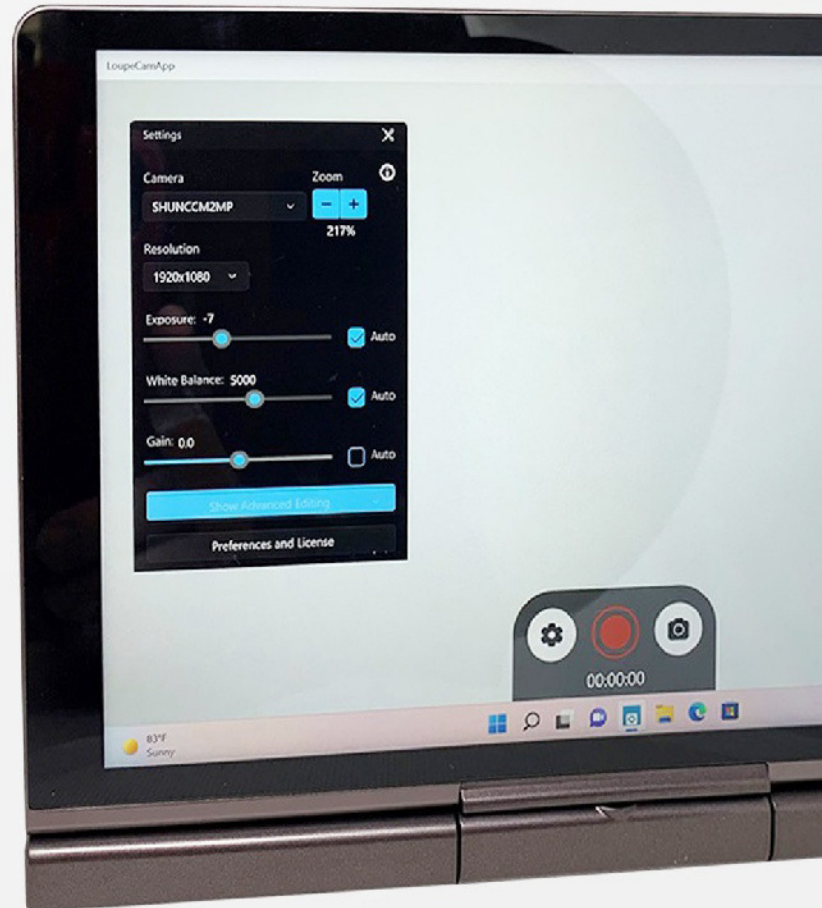

LoupeCam® App Hardware Requirements

In order to optimize the camera and software, the minimum system requirements to enjoy the full performance of the product.

Minimum System Requirements:

In order to leverage the best use of the 4K imaging, users should aim at procuring a computer geared towards the Gaming market, which offers optimized CPU & GPU (graphic cards).

System:

- Processor: Intel i7 .4GHz+ Preferred
- RAM: 8GB Preferred
- Graphics Card: High performing NVIDIA/Intel Iris Xe- Gaming Graphic Card recommended.
- 2 USB Type C port and/or Type A port
- Bluetooth

LoupeCam® App Software

Compatibility



Mac OS 12/13



Windows 10/11

Software Features Request:

Users can also submit features recommendations or new functionality requests to support@loupecam.com.

Use: "Software Feature Request" in the subject line.

LOUPECam[®]

FIRST POINT OF VIEW CAMERAS FOR LOUPES & HEADLIGHTS



(614) 901-0662



sales@loupecam.com



www.loupecam.com